

# OPTIONAL ACCESSORIES FORWARDERS



> #first in forest





# INTRODUCTION

*Welcome to our comprehensive guide on optional features for forwarder models!*

*This brochure is designed to guide you through the many options and features available to customize your forwarder to meet your specific needs and job requirements.*

*We are confident that this brochure will be a valuable resource as you explore the various options for forwarder models and help you make the right decisions to tailor your forwarder to your unique needs.*



**CUSTOMIZE YOUR MACHINE WITH OUR OPTIONAL FEATURES TO SUIT YOUR SPECIFIC NEEDS.**







# LIGHTING



## **MID-JOINT LIGHTS**

*Enhanced lighting around the mid-joint of the machine. A lamp on each side mounted on the crane tower illuminating the area between the cabin and the carriage.*



## **HIGH BEAM (2PCS)**

*Two additional high-beam lights mounted at the front of the cabin provide a long-range light pattern for better forward visibility. They can be connected to the machine's high beams to ALSO be used during road transportation.*



## **EXTRA WORK LIGHTS (4PCS)**

*Provides additional lighting to the already good illumination on the machine. An extra lamp on the side of the roof and one on the cab side below the side window. Applies to both the right and left sides of the machine.*



## **REAR BANK WORK LIGHTS**

*Four additional LED lights mounted on a ruggedly built console. Provides extra illumination behind the machine.*





## GATE WORK LIGHTS (2PCS)

Two LED lights mounted at the top of the gate to provide extra illumination in the cargo area. They complement best with dimmed lighting from the cabin roof using the dimmable lamps available there.



## CABIN ROOF WARNING LIGHTS (STROBE LIGHTS)

Factory-installed strobe light/warning light mounted on the four corners of the cabin roof. Connected to the machine's control system, it allows for control from the panels as well as from the control system's display.







**CABIN**



# COMFORT LINE GEN3

The gas/hydraulic cabin suspension reduces cabin vibrations and significantly improves the driver environment.

When the cabin suspension is activated, the cabin is raised approximately 5 cm to achieve free suspension travel and then operates fully automatically until the diesel engine is shut off or power is interrupted.

The system features variable damping with 3 different damping levels that the driver can easily adjust with a button press depending on the desired level of damping.

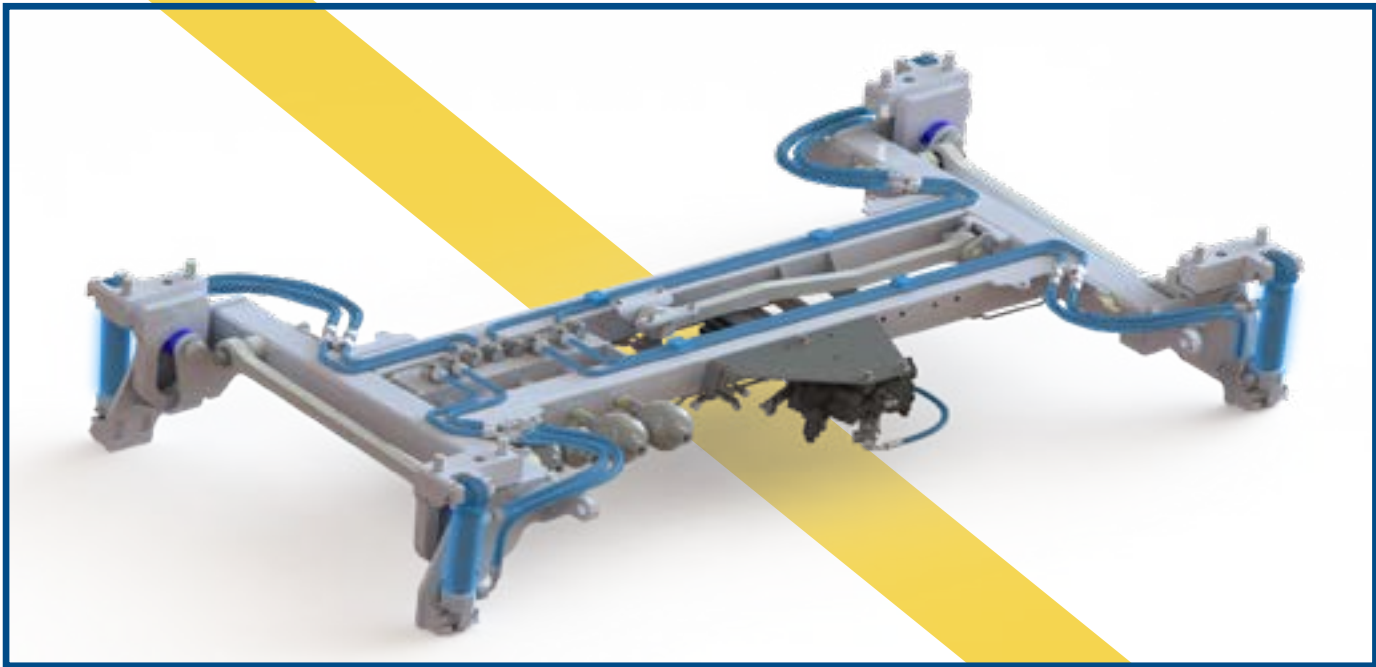

# DIESEL ENGINE HEATER



Webasto Thermo Pro 90, heats the engine and cab. Can be started with timer function, remote start from Rottne Connect, or via button in the cab.

# SUN SHADES

Sunshades in all windows. For front and rear windows, there is a shade installed both up and down. This allows for the possibility to pull the shade partially up or down as sun protection, without needing to cover the entire window.









## REAR SIDE WINDOW PROTECTION GRILLES

*Protective grilles mounted outside the rear side windows in the cabin.  
Provides good protection from branches that would otherwise easily reach the window  
and cause scratches over time.*



## PLANE DAMPER

### SINGLE

*Plane damper LP 2-way single damper laterally and has a compact low-profile design, designed to withstand high loads without play. The design is based on four long linear ball rows, resulting in a stable and play-free product. The 2-way damper eliminates most of the horizontal shaking and vibrations in most types of machinery. Damping is adjustable in 6 levels and can also be completely blocked. The damper's stroke length is  $\pm 40$  mm.*

### DOUBLE

*Plandämpare LP 4-way dampens in all directions and has a compact low-profile design and is designed to withstand high loads without play. The construction is based on four long linear ball rows, resulting in a stable and play-free product. The 4-way damper eliminates most of the shaking and vibrations in all directions and in most types of machinery. Damping is adjustable in 6 levels and can also be completely blocked. The damper's stroke length is  $\pm 40$  mm.*





## CHAIR TILT, SIT RIGHT

*An option that always ensures the chair remains straight sideways. An electrically driven tilt plate automatically adjusts the chair to the correct level.*



## STEERING WHEEL CONTROL; ORBITROL

*Hydraulic steering orbitrol with tiltable steering wheel. Allows steering with a larger wheel entirely hydraulically through an orbitrol valve.*

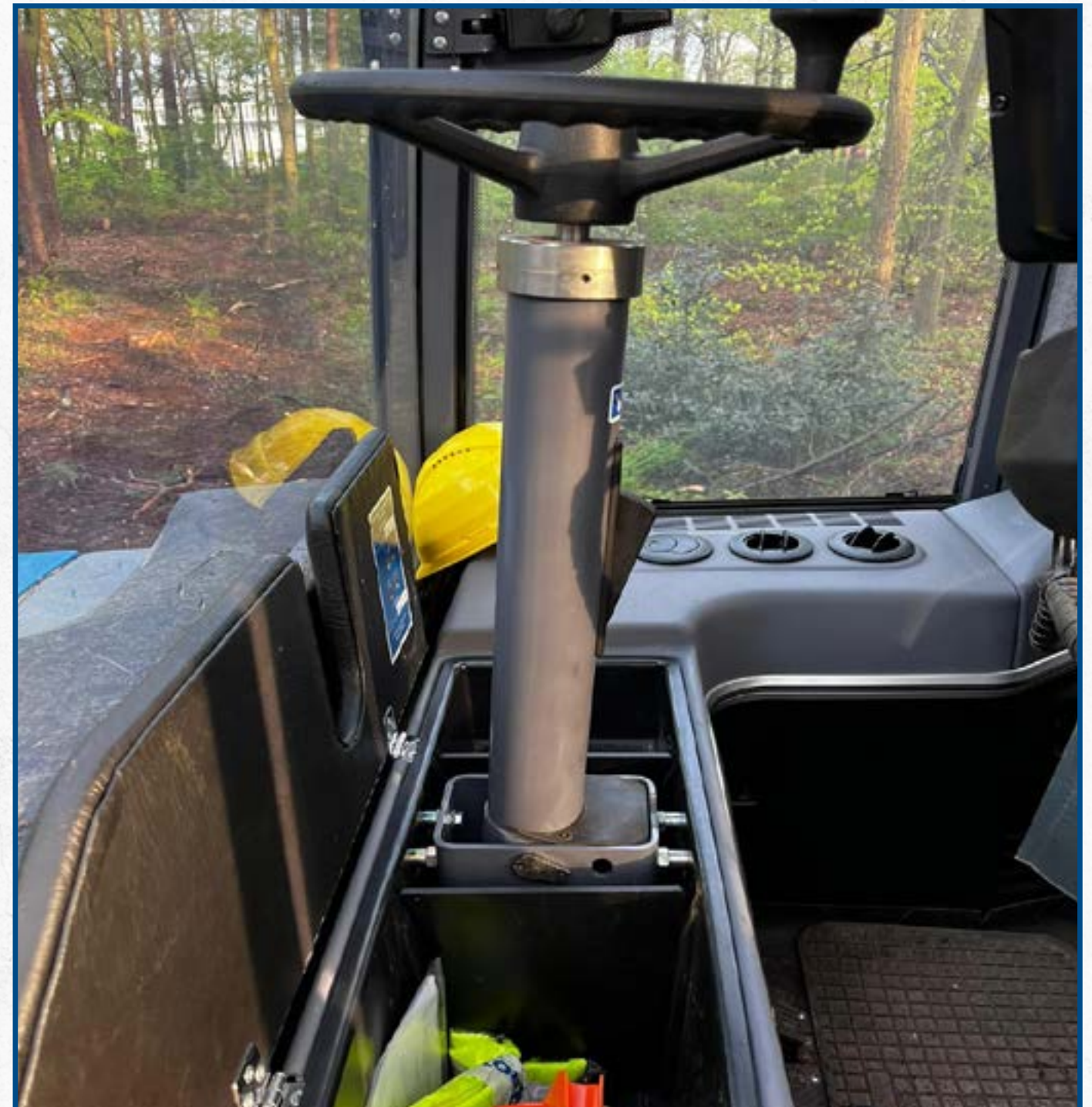



## FLOOR MAT BLACK / BLUE

*A carpet with very fine quality that protects the floor and gives a cozy impression. It is a diamond-patterned carpet with padding that fits perfectly with your ROTTNE machine.*



## SEAT COVER BLACK / BLUE

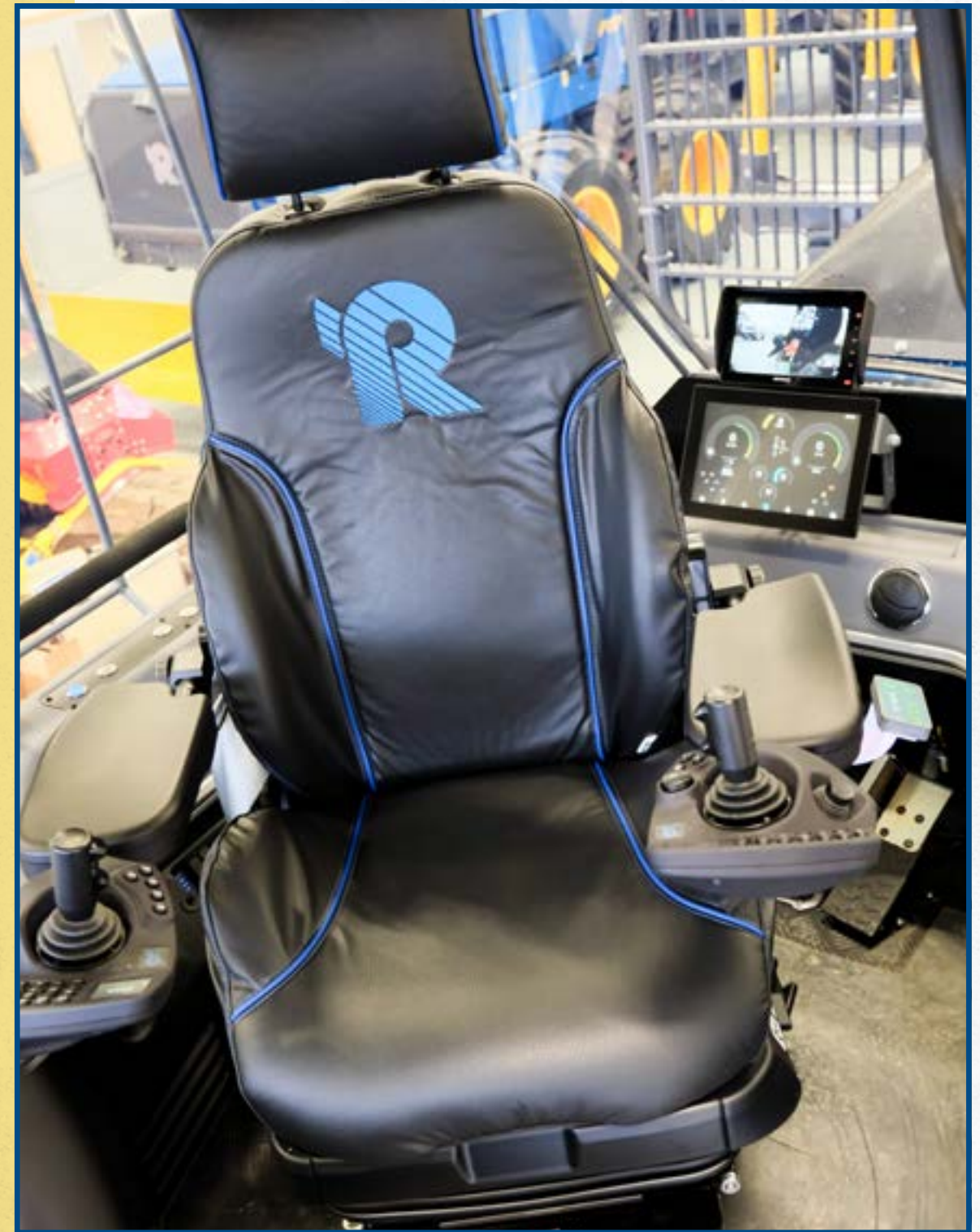

*Simple, smooth, and stylish seat cover that keeps the driver's seat fresh. Embroidered logo and contrasting lines in blue.*



A close-up photograph of a technical device, possibly a camera or sensor, mounted on a metal frame. The device has a rectangular lens assembly. In the background, a map or technical drawing is visible on a surface. The overall scene suggests a technical or scientific application.

# TECHNICAL OPTIONS



## RADIO DAB

*"Digital Audio Broadcasting" radio receiver for digital radio for countries that broadcast digital radio. Also works on the analog FM band.*

## FORWARDER COMPUTER DOP50 WINDOWS 10 (PC ONLY)

*Windows 10-based 12.1" computer with touch screen, designed to meet the requirements and needs of professional forestry applications. AMD Quadcore processor and multiple connectivity interfaces, USB, WiFi, Ethernet/LAN, 2 x DVI-D. Bright IPS panel with excellent visibility at wide angles, resolution 1280x800 with Multi-touch. Ignition control with direct machine battery connection. Safe shutdown function of the computer when the machine is turned off. Low power consumption in standby mode (does not drain the machine's battery).*



## EXTRA SCREEN FOR FORWARDER COMPUTER

*Extra screen, 15.6", mounted at the front of the cabin reflecting the rear screen in the cabin. Provides the ability to fully utilize the machine's computer even when sitting with the seat facing forward. Only available with skidder computer (DOP50).*





## F30 FORWARDER PROGRAM

*Dasa F30 is software designed for professional forwarders. It's easy to use and designed to facilitate the daily work of forwarder operators while maximizing performance and productivity. The Forester F30 software makes timber flow more efficient between the harvesting site and the industry receiving the harvested logs.*

*All features in Forester F30 for quality assurance, control, production reporting, and operations monitoring are designed according to the StanForD 2010 standard. In addition to working with the new StanForD2010 standard, Dasa F30 also handles the import of files in the StanForD Classic format. Dasa F30 receives production and GPS data from the harvester which, combined with GeolInfo, is used to optimize the route and ensure that all logs are forwarded out.*

*Dasa F30 can operate in mixed fleets, so it doesn't matter if log data is generated by a harvester from another brand. Alternatively, Dasa F30 can receive its work instructions as specific StanForD2010 files such as FOI (Forwarding Object Instruction) and/or FDI (Forwarding Delivery Instruction).*

*It's very easy to monitor operational follow-up in the integrated calendar view, where the driver can also add comments. In the settings menu, it's possible to schedule reports that are automatically stored, for example, every fourth hour or at the end of a shift, to ensure that the client's production data is secured. When it comes to security, Dasa F30 also includes a comprehensive system backup and restore feature.*



## GEOINFO INSTALLED SOFTWARE

*GeolInfo is an active navigation application developed specifically for use in forestry machinery, taking your productivity to a new level. GeolInfo supports geographic information in the StanForD format and is used in both harvesters and forwarders.*

*GeolInfo creates a track log on a map showing where the machine has been driven. The track log can be transferred to a forwarder, and GeolInfo can use the harvester's production file to show where logs of different tree species are located. Drivers can easily create map objects, such as marking out skid trails or obstacles. GeolInfo is easy to use and designed to fully support touch screens. All key functions are available on the screen via large, distinct buttons.*

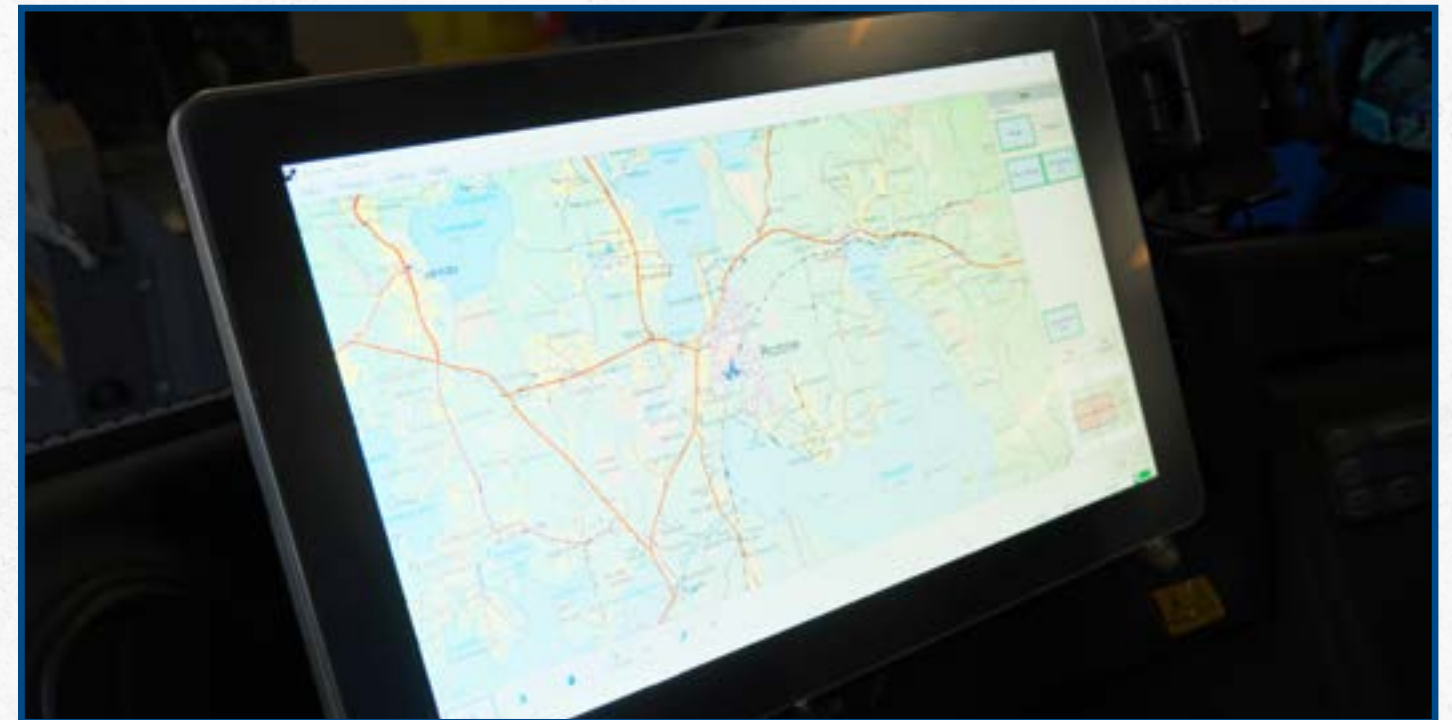

## GEOINFO EXTRA LICENCE

*Extra license to use GeolInfo on an external Windows device. Provides a great opportunity for pre-planning of stands before harvesting.*



## REAR CAMERA

Rear camera system with cameras mounted front and rear, along with a screen mounted in the rear of the cabin. The control system automatically adjusts the display to the correct camera depending on the direction of the machine.

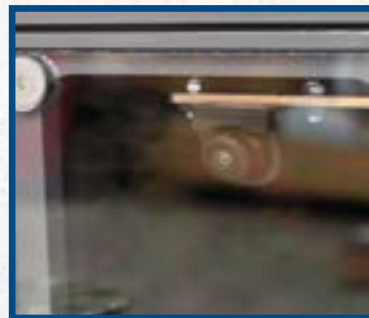

## EXTRA SCREEN FOR THE REAR CAMERA

An additional screen for the rear camera system can be mounted at the front of the cabin if you want to use the rear camera even with the seat facing forward. The control system automatically adjusts the display to the correct camera depending on the seat and machine's direction.



## SUBWOOFER



Blaupunkt GTw 190A Bass Speaker mounted on the back of the seat provides a better sound experience. 150W

## ADDITIONAL REMOTE CONTROL FOR DOOR LOCKS

The machine comes with 2 remote controls as standard. Please consider adding extra remote controls if needed.



## ROTTNE CONNECT-TRIAL PERIOD

Rottne Connect stores all current machine data such as production, machine position, technical utilization rate (TU), time to next service, alarm history, error messages, current levels of diesel and oil, etc. All information can be accessed via computer or mobile phone logged into the machine. Applies for 24 months.



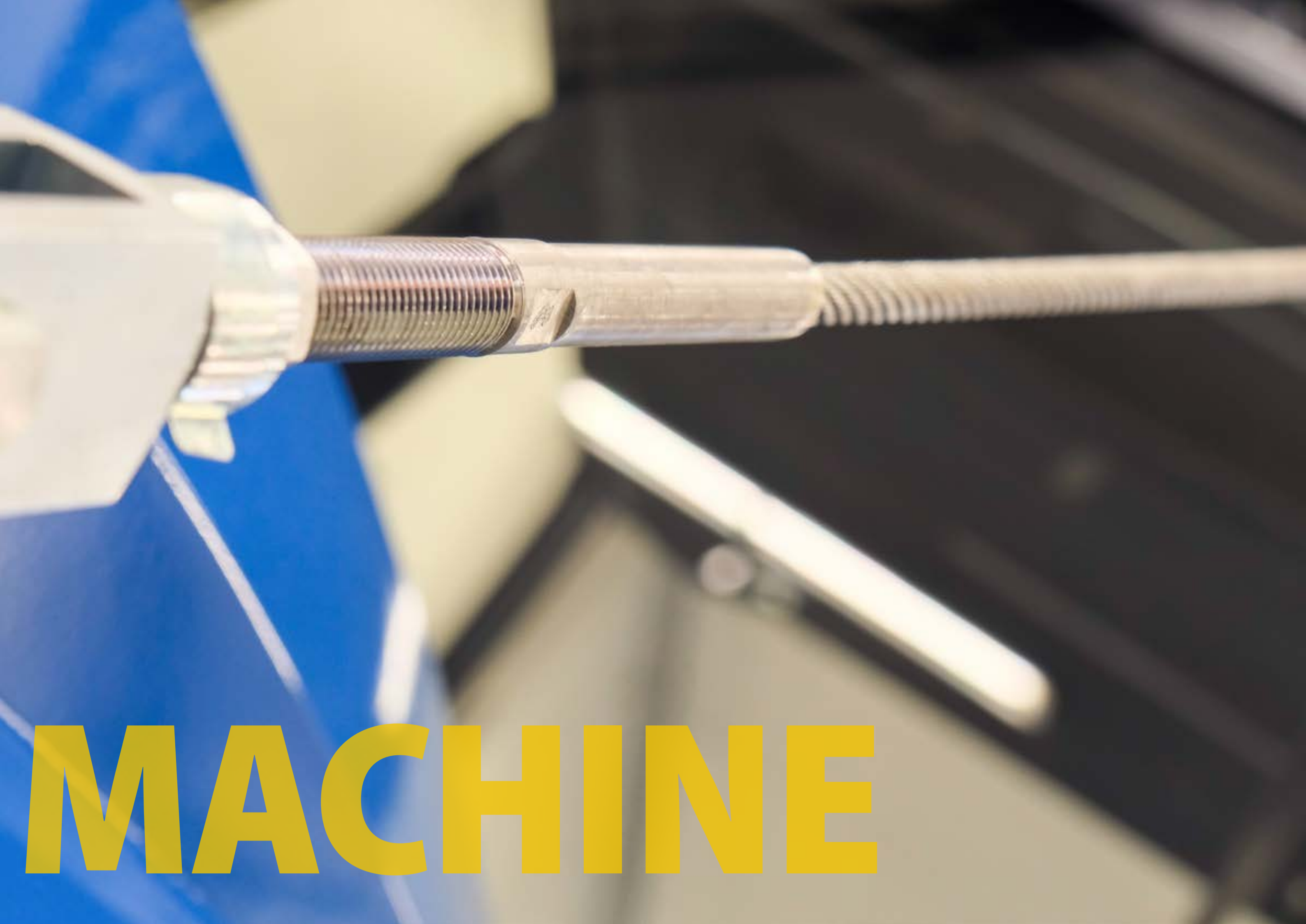

**MACHINE**



## REFUELING PUMP FOR DIESEL

*Electric pump for refilling diesel in the tank. Suction hose with quick coupling and suction strainer are used during filling. The fuel is pumped to the machine's tank through a filter to reduce the risk of contamination in the system. Activated with a button and automatically shut off via the tank's level sensor.*

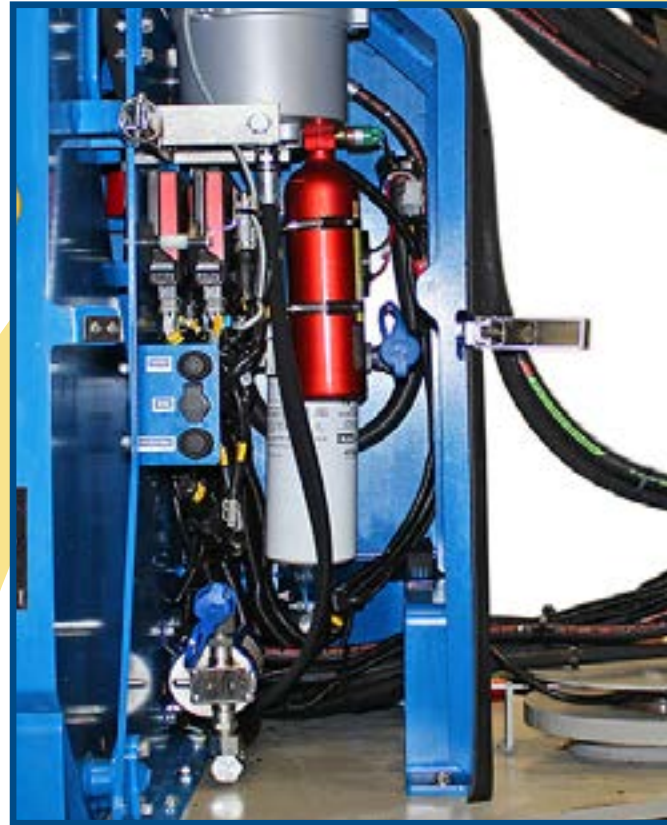

## REFILLING PUMP FOR HYDRAULIC OIL

*Electric pump for refilling hydraulic oil in the tank. Suction hose with quick coupling and suction strainer are used during filling. The oil is pumped to the machine's tank through the machine's filtration system to reduce the risk of contamination in the system. Automatic shut-off during filling via the tank's level sensor.*

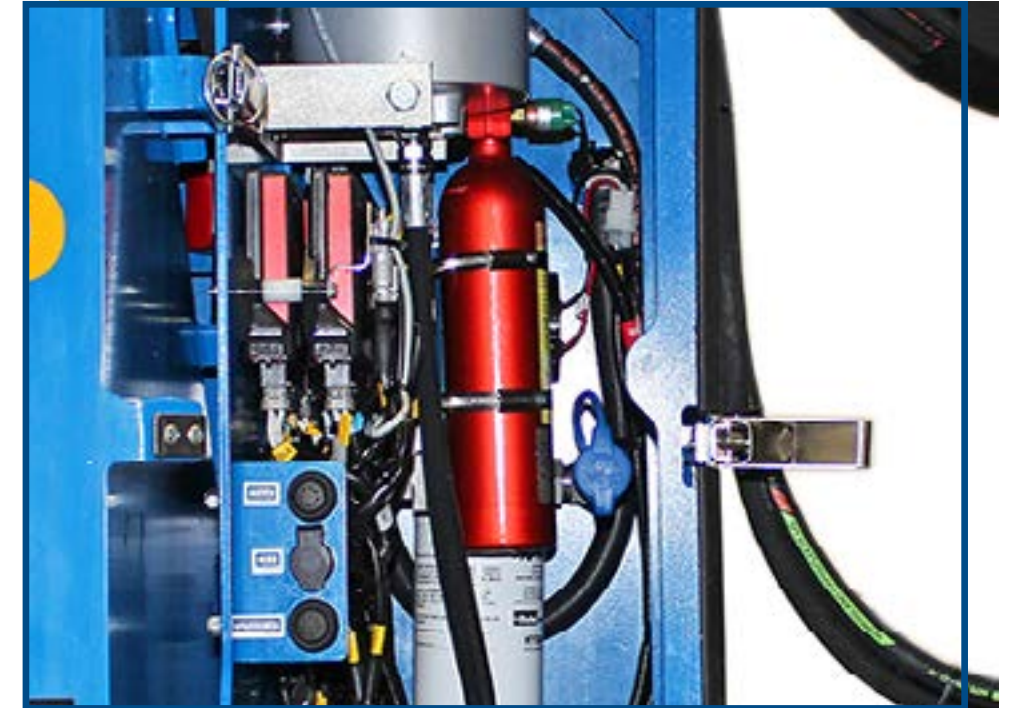

## VACUUM PUMP FOR WORKING HYDRAULICS

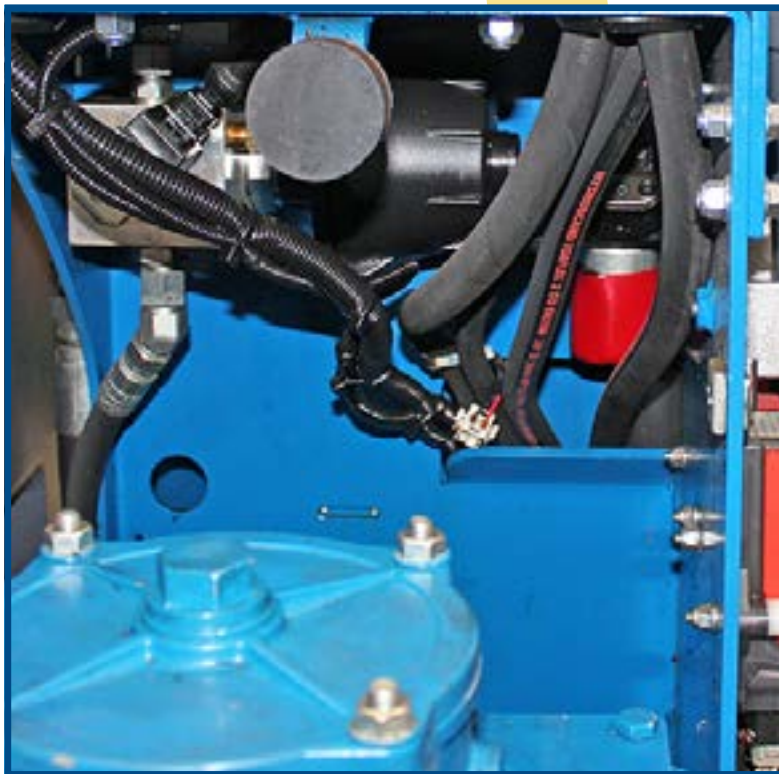

*A vacuum pump connected to the machine's hydraulic oil tank creates a vacuum in the tank to prevent spills when servicing work needs to be performed on the hydraulic system. The pump is activated from the machine's control system. Avoiding oil spills is beneficial for both the environment and the economy.*

## ADDITIONAL COOLING KIT FOR TRANSMISSION

**NOTE: ONLY FOR F13/F15**

*Improved cooling performance for the transmission can be installed. Recommended if you have long driving distances and/or hot climate.*







# DOZER BLADE EQUIPMENT

Dozer blade with float mode, designed to fix the yard, remove logging residues and snow, etc., or to improve a basic road. The blade is controlled with a button or lever from the control panel.



# FRONT GUARD

Extra protection for the front of the machine. Provides excellent protection for the front when driving in areas with a lot of undergrowth and logging residues. It is also possible to cover the holes for the lights with protective glass or metal, see upcoming options.

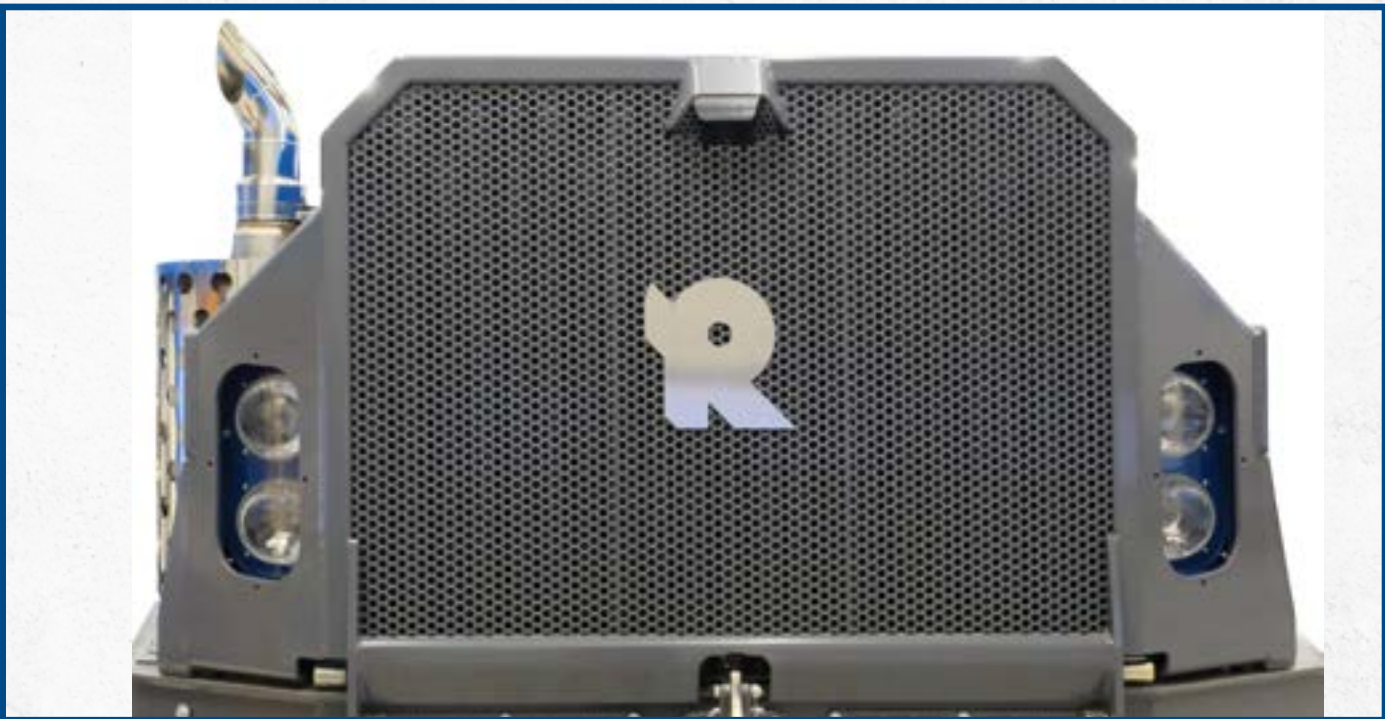

# DEFLECTOR FOR THE CABIN

Deflectors that help keep branches from hitting the front windshield. They protect the cabin when driving in harvest areas with a lot of undergrowth and during thinning operations.



# PROTECTIVE PLATE

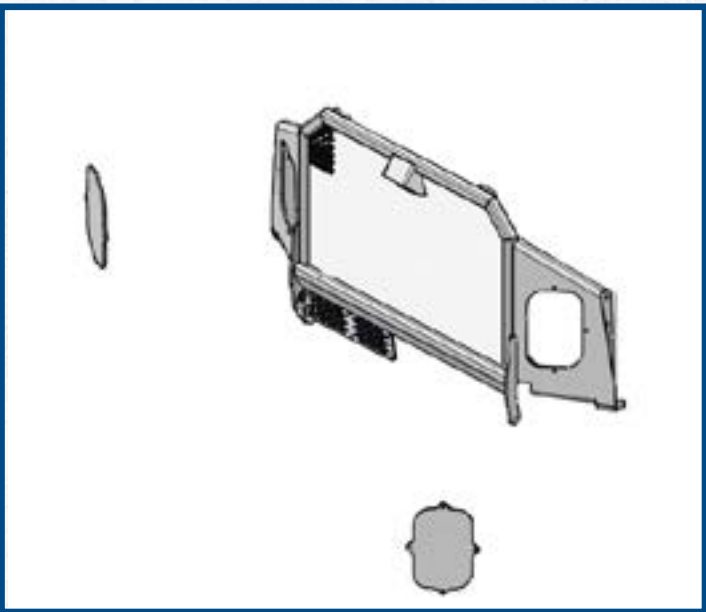

Plates to cover the holes around the lights, providing extra protection for the lamps. They must be removed when driving on public roads.

# PROTECTIVE GLASS

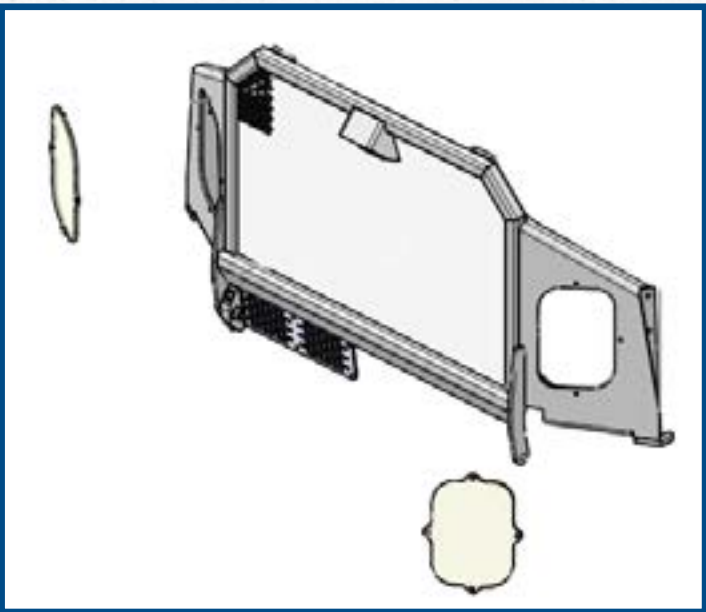

Protective glass to cover the holes around the lights, providing extra protection for the lamps. They do not need to be removed when driving on public roads.



## CENTRAL LUBRICATION

INCLUDING FILLING TOOL FOR GREASE CARTRIDGE 400G

Central lubrication from Lincoln controlled by the machine's control system. Automatically lubricates the machine at adjustable intervals. The system is equipped with a sensor for operation indication and alarms in case of empty container or if there is a stoppage in the system.



## EXTRA FOAM FIRE EXTINGUISHER

2 X 9 LITERS WITH HOLDERS

Two 9-liter foam fire extinguishers with convenient storage for those who require it.



## SPRINKLER

Fogmaker ECO I is an environmentally friendly sprinkler system that meets the latest standards for fire protection in the Nordic region. The extinguishing agent of the system is completely free from PFAS, and all pressurized containers are monitored by the machine's control system. The sprinkler automatically activates using a detector loop that triggers if a fire occurs. The system extinguishes the fire with a water mist distributed through multiple nozzles. It can also be manually activated with a button both inside the cabin and from the outside.



## RECOVERY WINCH 6 TONS

INCLUDING RADIO CONTROL - NOTE: ONLY FOR F13/F15

Recovery winch mounted in an extra box at the rear of the carriage. The box also contains a valve for hydraulics, tow hitch, driving lights, and the reverse camera has also been moved to the winch box, along with sturdy attachment points for the winch hook when using a block. 30m steel cable.





# OPTIONAL FLUIDS

## Hydraulics oil Hindemith 32-68

*Hydraulic oil for mobile and stationary hydraulic systems. Specifically designed for hydraulic systems requiring oil with a very wide temperature range. Contains ashless (zinc-free) anti-wear additives.*

## Hydraulic oil Biohydraulics 32-68

*Biodegradable hydraulic oil based on saturated esters. Recommended for use in sensitive areas where high biodegradability is required. Listed on the SP list, which indicates products that meet the environmental requirements of Swedish standards. Developed for systems with high operating temperatures and where good oxidation stability is required.*

## Glycol Q8 long life

*Long Life glycol based on monoethylene glycol. Q8 Long Life Plus Glycol is a type called Si-OAT and combines the benefits of a glycol containing silicates with one based on so-called OAT technology. The benefits are many - including unsurpassed corrosion protection.*

## Glycol Rottne anti freeze

*Rottne Anti Freeze Bio is a ready-to-use product. Mixing ratio is 50/50, mixed with deionized water.*

## SERVICE AND WARRANTIES - 750 HOUR INTERVAL

*To get more hours out of your machine and reduce service costs, you can extend the service interval from 500 hours to 750 hours. The engine oil quality is monitored instead through continuous oil samples. All other service on the machine is also adjusted to the longer interval.*





## CLEAR COATING

Everything on the machine that is painted blue will receive a layer of clear coating. This will give the machine a better appearance and provide good protection against scratches from the normal wear and tear a forestry machine is subjected to.



## REFILLING PUMP FOR GREASE IN LARGER CONTAINERS (DRUMS)

Hand pump designed to be mounted on a drum of grease.



## FIELD REPAIR KIT BASIC

Anything can happen with a forestry machine, so it may be wise to purchase our field repair kit. It consists of carefully selected parts that we know from experience can be handy to have close at hand if something were to happen. You can then easily refill it as needed through your service provider.



## ASSORTMENT BOX + HOSE FOR CENTRAL LUBRICATION

Assortment box with nipples and hose to be able to maintain central lubrication systems. Good to have on hand in case any of the hoses for the central lubrication should break.



## WITHOUT REARVIEW MIRRORS

For the markets that do not have legal requirements rear-view mirrors or never intend to drive the machine on public roads, it is possible to get the machine delivered without rearview mirrors.





[WWW.ROTTNE.COM](http://WWW.ROTTNE.COM)

